

REV	DATE	REVISION DETAILS	APPD
更改号	日期	更改内容	审核并批准

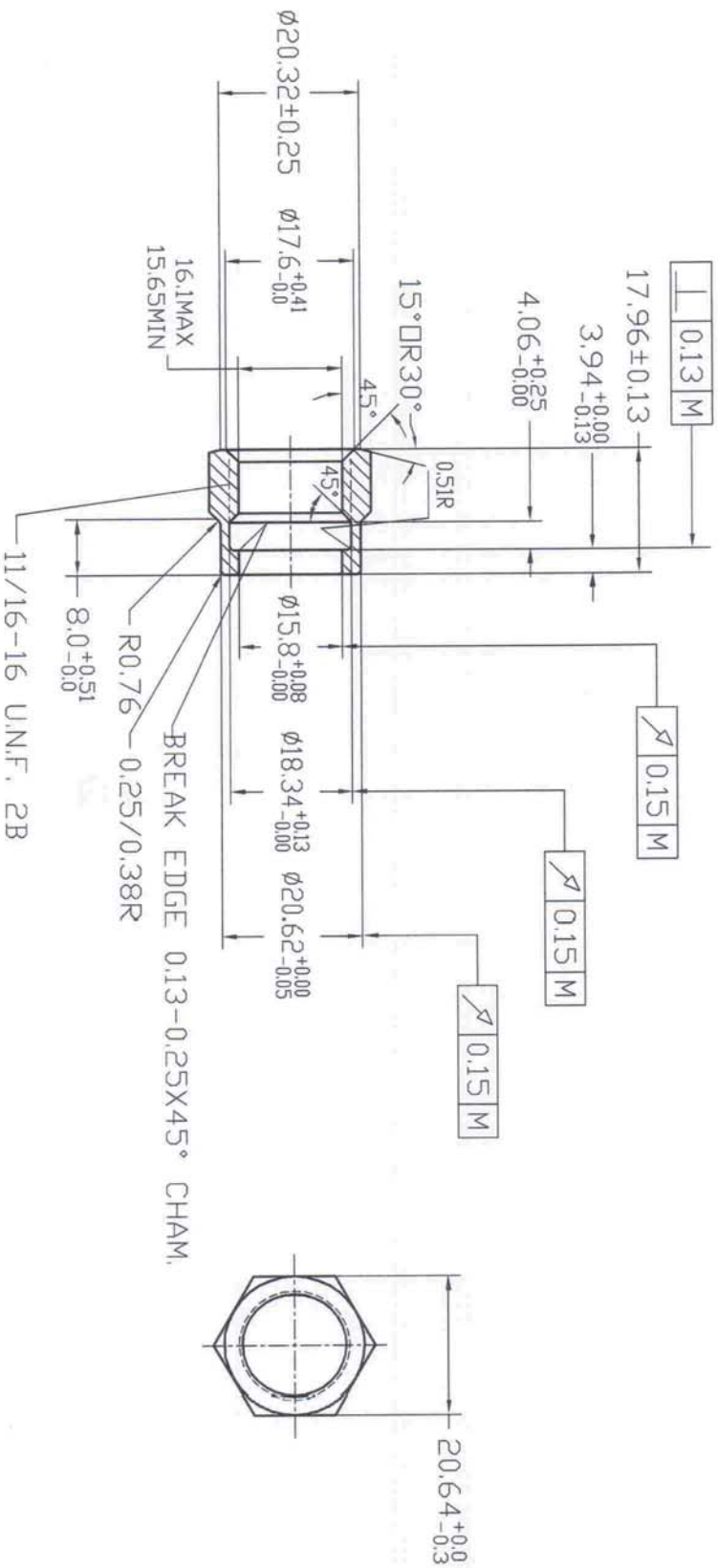

UNLESS SPECIFIED  
 ALL DIMENSIONS IN mm  
 MACHINED SURFACES Ra=3.2um  
 ANGLE TOLERANCES  $\pm 1^\circ$   
 DECIMAL TOLERANCES:  
 .X:  $\pm 0.5$   
 .XX:  $\pm 0.25$   
 .XXX:  $\pm 0.127$

未注公差  
 图示尺寸单位为mm  
 表面粗糙度Ra=3.2um  
 角度公差 $\pm 1^\circ$   
 小数部分公差:  
 .X:  $\pm 0.5$   
 .XX:  $\pm 0.25$   
 .XXX:  $\pm 0.127$

MATERIAL	Chinese steel 45	PART NO	零件名	40945-SWIVEL NUTS 6 #	APPD:	批准	Zhangjian	DRN:	制图	Tanghaolin
FINISH	Remove all sharp edges, burrs, slivers and swarf, break all edges 0.127-0.254mm, 去除所有毛刺, 铁屑等残留物, 锐边倒钝0.127-0.254mm. ZINC PLATED WITH TRIVALENT CHROMATE AND NO RED CORROSION IN 96 HOURS SALT SPRAY TEST. 镀三价铬锌, 银白色, 96小时盐雾试验无红斑.	SCALE:	NTS	DATE:	日期	07/16/13	CHK:	审核	LiJunbiao	2013.10.03